

## 1 - Before syringe filling-up

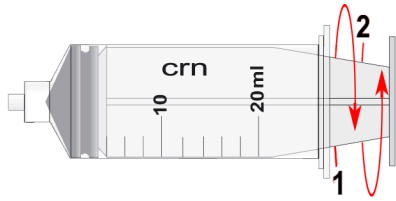

Begin by unscrewing the piston rod half a turn and then back again before moving the plunger. This way it will be easier to remove the piston rod after the syringe has been filled.

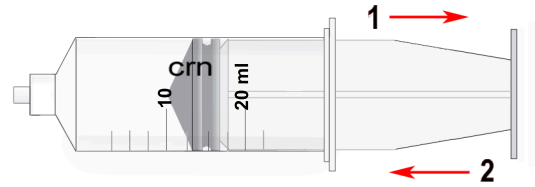

Slide the plunger twice along the syringe to spread the lubricant along the walls.

## 2 - Syringe filling-up

Draw up the drug slowly.

The syringe is not to be filled up beyond the maximum volume allowed of 10 or 20 ml. The piston rod is to be unscrewed with a fairly swift movement.

## 3 - Connecting the syringe onto the pump

Connect the infusion set (or the luer cap) to avoid any possible drug leakage during syringe connection onto the pump.

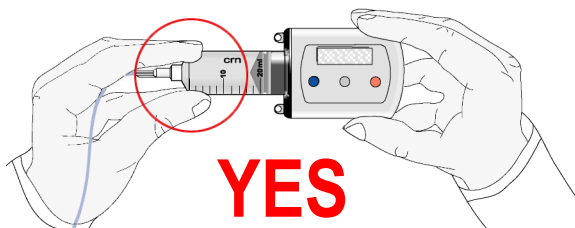

Hold the syringe from the syringe body upper top during syringe connection onto the pump and not along the syringe body wall.

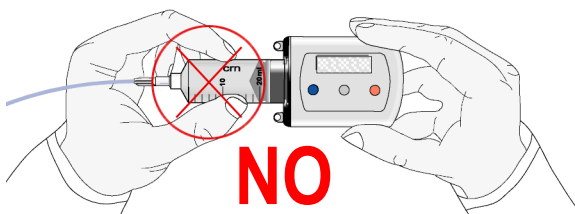

During connection avoid applying pressure onto the syringe body walls since this could cause drug leakage from piston rings.

During syringe filling up and connection onto the pump a light drug leakage may occur between the first and second rubber piston retaining ring: such condition does not affect either the correct syringe working or drug delivery.